

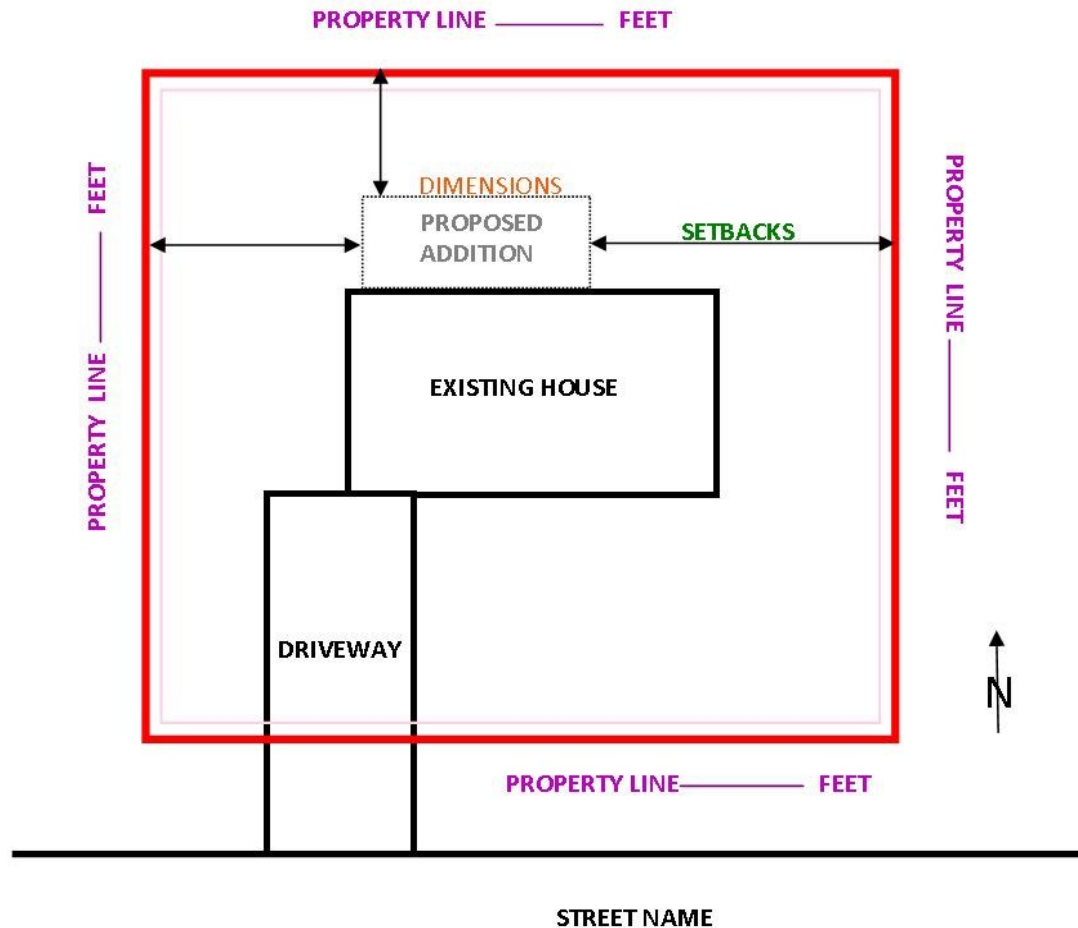

# SITE PLAN SAMPLE

DEPARTMENT OF  
 URBAN DEVELOPMENT  
 PLANNING DIVISION  
 P.O. Box 1780  
 Gulfport, MS 39502  
 Phone: 228-868-5710  
 Fax: 228-868-570  
[www.gulfport-ms.gov/planning.shtml](http://www.gulfport-ms.gov/planning.shtml)  
 Wm. H. Hardy Building  
 1410 24<sup>th</sup> Avenue  
 Gulfport, MS 39501



### Instructions:

1. Provide Project Address, Zoning, Parcel number, north arrow.
2. Show all existing and proposed structures.
3. Show properly dimensioned property lines.
4. Provide dimensions and setbacks of the proposed structure (s).

Project Address: \_\_\_\_\_

Zoning : \_\_\_\_\_

Parcel Number: \_\_\_\_\_